

Approved  
Third Floor Level  
1:100

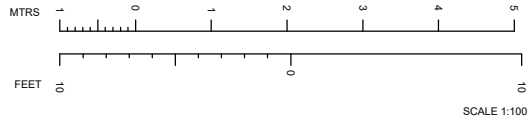

**THIRD FLOOR APARTMENT**

INTERNAL AREA: 81.0 sqm  
 EXTERNAL AREA: 9.0 sqm  
**TOTAL AREA: 90.0 sqm**

CLIENT:	
LOCATION:	ZEJTUN
DATE:	22.09.22
DRAWN BY:	CC
SCALE:	1:100

PROJECTION DESCRIPTION:	<b>APPROVED 2-BEDROOM APARTMENT IN ZEJTUN</b>
TITLE:	<b>PROPOSED LAYOUT</b>

JOB NO: **22.42**  
 DRAWING NO: **A01 (A4)**

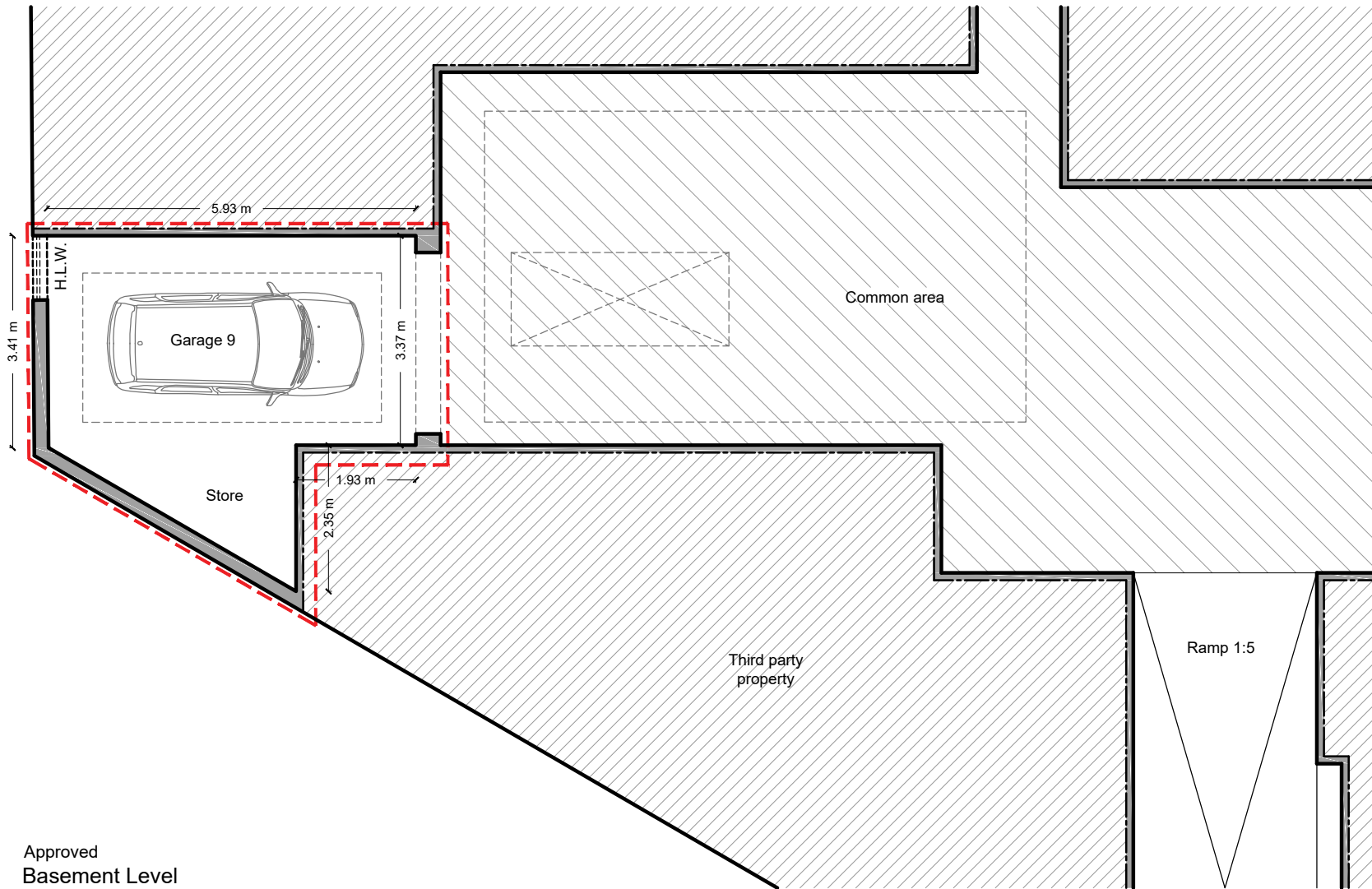

Approved  
Basement Level  
1:100

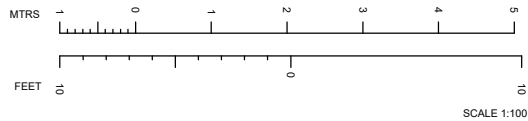

**BASEMENT GARAGE WITH STORAGE**

TOTAL AREA: 28.6 sqm

CLIENT:	
LOCATION:	ZEJTUN
DATE:	22.09.22
DRAWN BY:	CC
SCALE:	1:100

PROJECTION DESCRIPTION:	<b>APPROVED BASEMENT ONE CAR GARAGE WITH STORE IN ZEJTUN</b>
TITLE:	<b>PROPOSED LAYOUT</b>

JOB NO: **22.42**  
DRAWING NO: **A02 (A4)**